

# Smart Life App – Add Device Guide

---

This guide explains how to add a smart switch to the Smart Life app step by step. Illustrations are included to make the process easier for first-time users.

## Before You Start

Please confirm the following before proceeding:

- Smart switch is installed correctly and powered ON
- Phone is connected to 2.4GHz Wi-Fi (not 5GHz)
- Zigbee Gateway is in operating
- You are close to the switch during setup

## Step 1 – Install and Open Smart Life App

Download the Smart Life app from the Apple App Store or Google Play Store. Open the app and log in using your email address or mobile number.

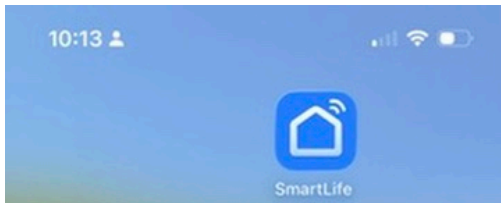

## Step 2 – Put the Device into Pairing Mode

Press and hold any button on the smart switch for **5–10 seconds** until the LED indicator starts blinking.

- Fast blinking: EZ Mode (recommended)
- Slow blinking: AP Mode



### Step 3 – Add Device in the App

Open the Smart Life app, tap the '+' icon in the top-right corner, then select 'Add Device'.

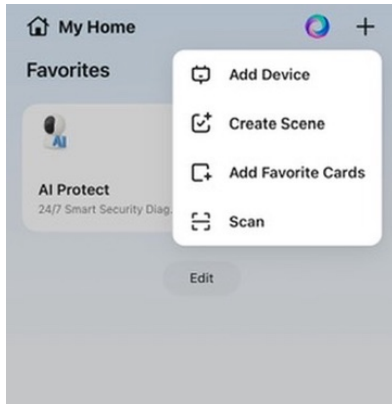

### Step 4 – Select Pairing Mode

App is searching to nearby Device in pairing mode automatically, please make sure you are close to device. If App is unable to pair and recognize device, please repeat Step 2



## Step 5 – Device Connection

The app will now connect to the device. This process may take up to two minutes.

Once connected, rename the device (for example, 'Living Room Light') and assign it to a room.

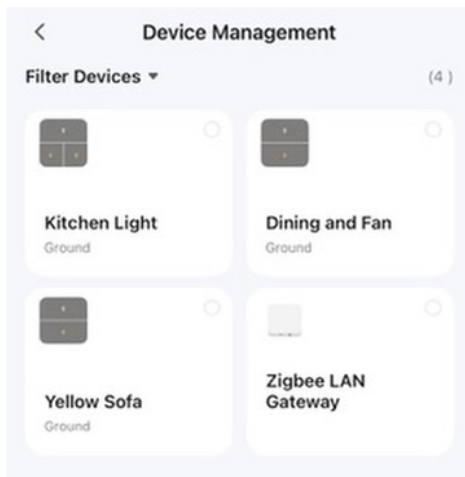

## Step 6 – Test the Device

Use the app to turn the switch ON and OFF. Also test the physical switch to ensure normal operation.

