

# Smart Life App – Scene Guide (Schedule Setting)

This guide shows home users how to create and use Scenes in the Smart Life app to setup scheduled action.

## Usage Cases Example

1. You might be away from home to 1 week, and you wish to keep light on/off at certain schedule for security reason.
2. You might wish to light on certain area eg. Hallway, Landing after sunset.
3. All light off after 10pm

## Before You Start

- Ensure your devices are already added to Smart Life and appear in your Home list.
- Make sure your phone has internet access (Wi-Fi or mobile data).
- If you plan to use location-based automation, allow location permission for Smart Life.

## Step-by-Step: Create a Schedule Scene

### Step 1 – Open the menu and create scene

1. From the Home screen, tap ' + ' icon at top right then selection “Create Scene”
2. Select “Schedule” form menu

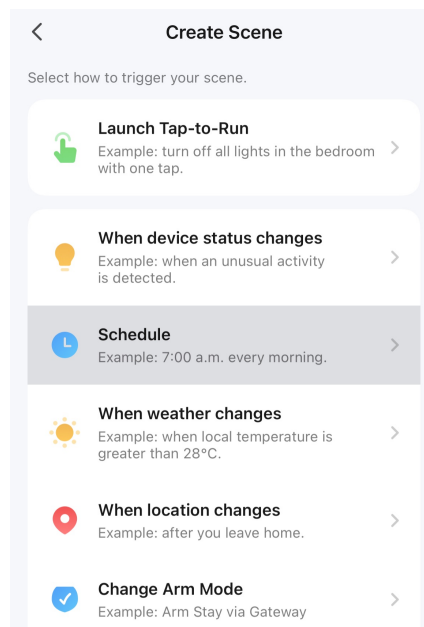
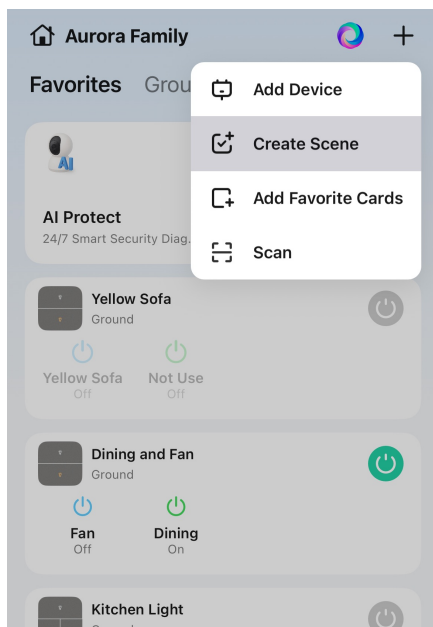

## Step 2 – Setup Timer

3 options are available for timer setting

- Specific Time > User define
- Sunrise/ Sunset > System time by your current location

In this demonstration, we select Specific Time and define the time required for action. After “confirm”, then select Repeat patten.

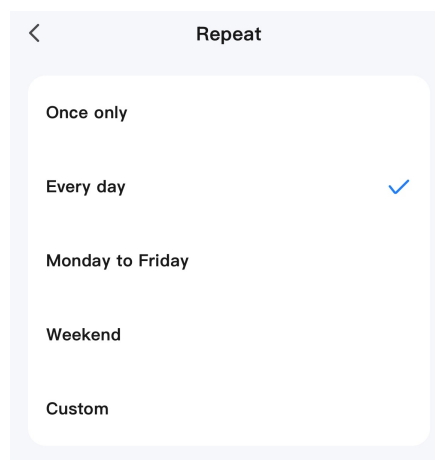
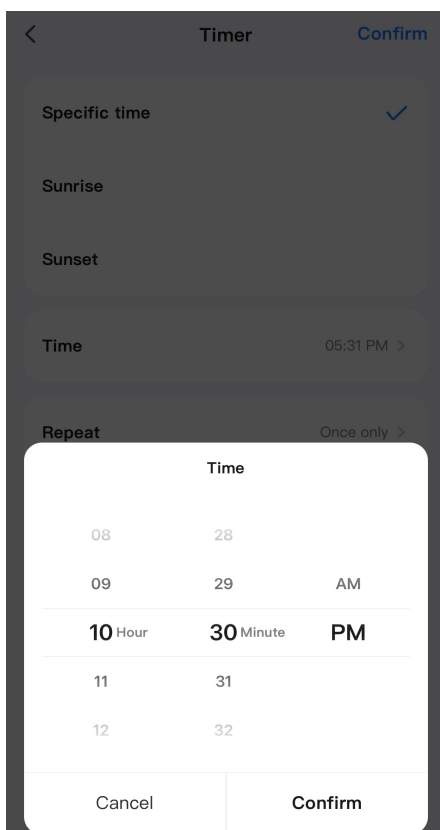

## Step 3 – Select Devices and Set Action

At “Then” section, add “Task” in order to select “Device”

Select action either “ON/OFF” and select devices that you wish to be included in this schedule action.

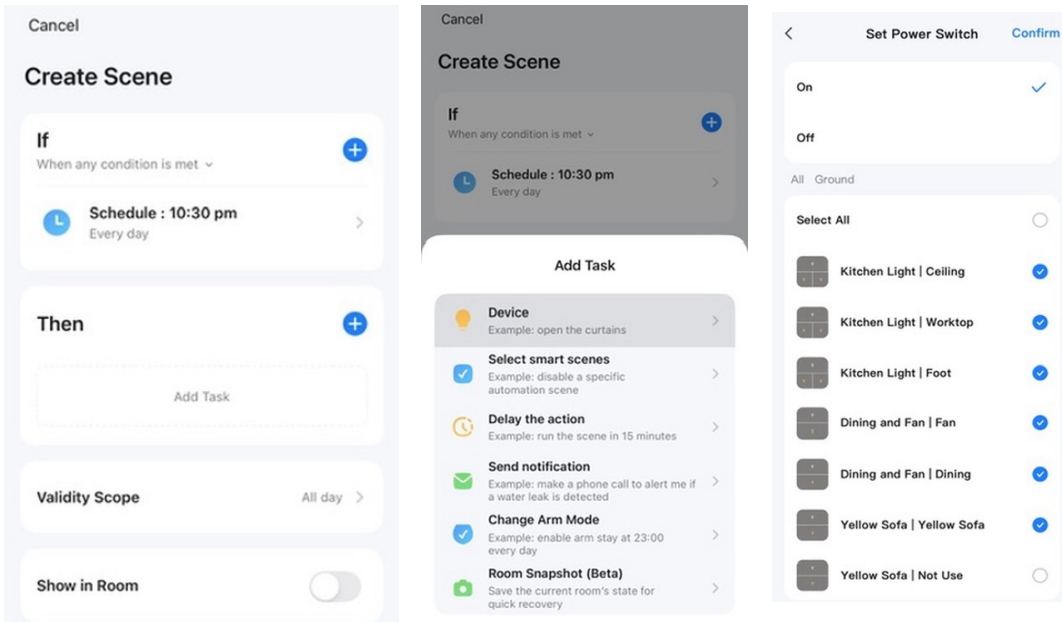

## Step 4 – Save and Name the automation

1. Click Save once all set  
IF (time set), Then (device and action)
2. Name this Automation eg. Light Out 22:30

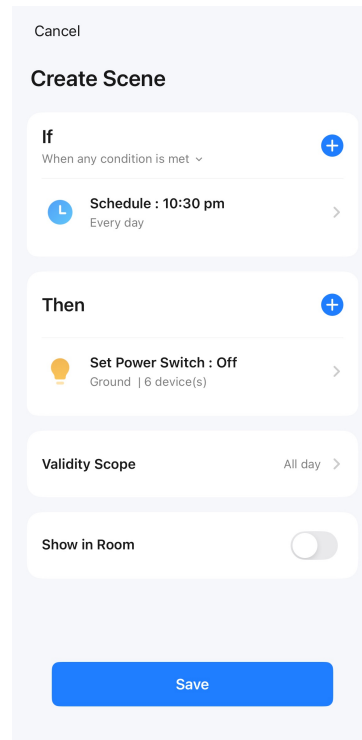

## Step 5 – All Done

At automation tab, you can see a schedule is set, and it will run automatically as per setting.

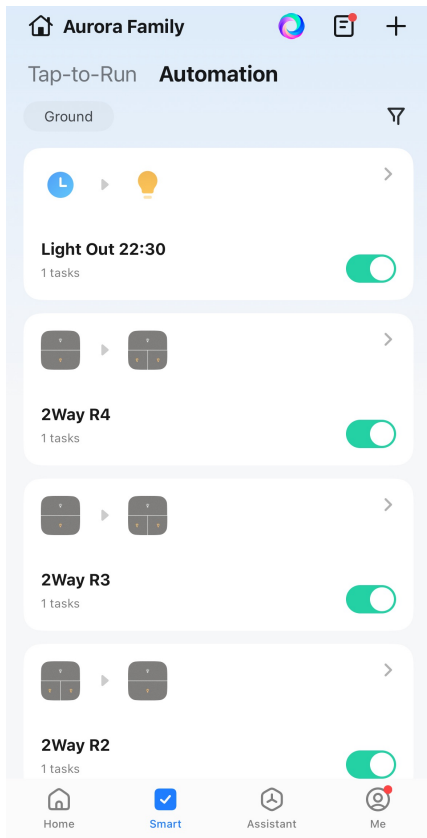

## Step 6 – Test your setting

You can test and see if they lights are working per schedule.

### **Home User Tips (Avoid Common Problems)**

- Keep scene names simple: 'Good Morning', 'Bedtime', 'Away Mode'.
- If an automation does not run, check the trigger conditions and effective period.
- For Zigbee devices, confirm your Zigbee gateway is online.
- If devices respond slowly, check Wi-Fi signal strength and router stability.